

PPO Smart Imaging System Specifications

(Waterfall Inspection)

PPO's Smart Imaging System is a proven solution for both detecting and classifying foreign materials, and assessing quality, fat/lean composition, tenderness and more. The PPO Waterfall Configuration is designed for double-sided inspection, with multi-rejection mechanisms. It meets all applicable food-safe sanitary design principles and standards including NAMI and CFIA, and is IP69K compliant.

Compressed Air		Environmental		
Pressure 80 PSI minimum 145 PSI maximum Consumption 35 CFM maximum (actual consumption dependent on product quality) Supply Quality 7:4:4 as per ISO 8573.1 5 micron filtration		Standard Operating Temperature Range 0C to +10C Non-operating Temperature Range -25C to +60C (Transportation and storage) Humidity 90% R.H. maximum, non-condensing Ingress protection rating IP69K or equivalent Clean Air Intake Measurements: Intake Air Consumption: 400 CFM MIN Intake Air: 2-8°C		
Speed Capability	Size/Weight	HMI/PLC	Electrical	Connectivity
Supports line speeds up to 120 ft/minute and up to 50,000 lbs/hr, depending on the application	Conveyor Belt width (in-feed and out-feed): 30 inches (physical width) Customizable per application	10 Inch Touch Screen Panel (IP67, encased touch screen) PLC: Allen Bradley Compact Logix	Power Consumption 3 Phase, 480V, 35A	Single Gigabit Ethernet port (RJ-45), with appropriate controls to allow access via VPN

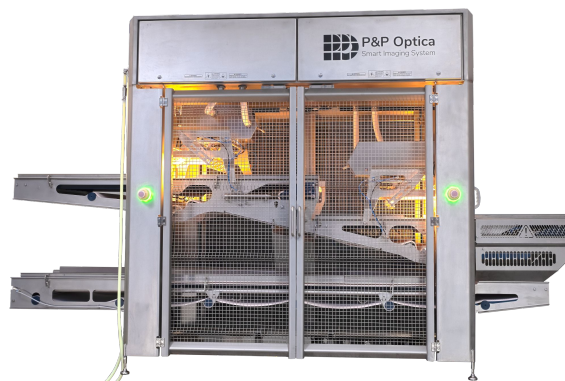



Approximate Dimensions

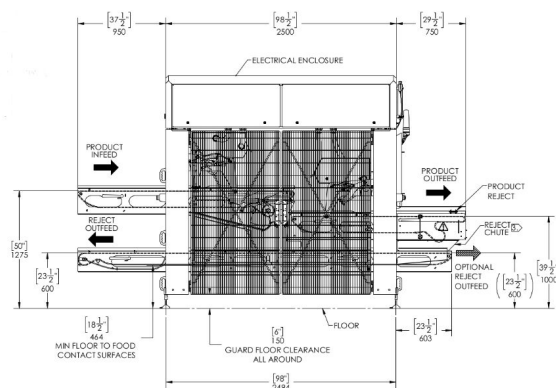
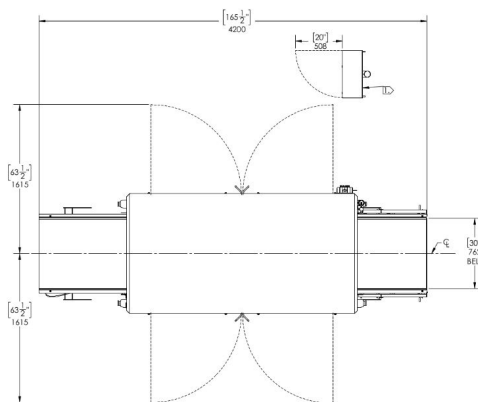

- Efficient clean-in-place capability
- Separate HMI enclosure
- Adjustable belt guides
- Connects easily to 3rd party sorting devices and 3rd party belting
- Multiple rejection mechanisms available
- Intralox Series 100 flat top X-ray detectable white acetyl belt

- Fully enclosed imaging and materials handling area with safety interlocks
- Compliant with CSA Z43216, IEC EN 61508, and ISO 13849-1
- Compliant to applicable electrical and safety standards including UL, CSA, OSHA, and NFPA 79
- Accredited licensing body in the U.S. and Canada